



Victor's Lavender Farm
 3743 Old Olympic Highway | 360-681-7930
victorlavlender.com
 Memorial Day - August | Tuesday-Sunday 10-5



Lavender Connection
 1141 Cays Rd | 360-681-6055
lavenderconnection.com
 Memorial Day - Labor Day | Fri-Mon 10-5:30



Sequim Lavender Weekend
 July 19-21, 2024
 Always the third full weekend in July
visitsunmyssequim.com



Jardin du Soleil Lavender
 3932 Sequim Dungeness Way | 360-582-1185
jardindusoleil.com
 April - September (Weekends Oct - Dec)
 Every day 10-5 (July 9-6)



Cedarbrook Lavender & Herb Farm
 120 W Washington Street | 360-683-7733
cedarbrooklavender.com
 Year round | Mon-Sat 10-5, Sunday Noon-3pm



B&B Family Farm
 5883 Old Olympic Hwy | 360-504-2585
bbfamilyfarm.com
 May 1 - September 30 | Every day 9-5

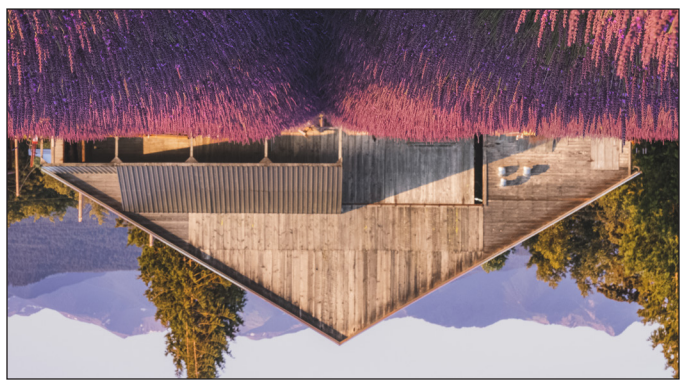

LAVENDER FARMS Each farm has something special to offer - Visit them all!

Port Angeles Farmers Market
 year-round fresh
portangelesfarmersmarket.com

Lavender Weekend
 Fri July 19 11-5
 Sat July 20 9-5
CELEBRATE Lavender **LIKE A LOCAL**

 Regular Hours: Saturdays, 9-2
 farm fresh food - home goods - jewelry - wellness

DUNGENESS RIVER NATURE CENTER
dungenessrivercenter.org

Are you dreaming of a getaway filled with golden rays and purple paths? Explore the Sequim Lavender Trail, nestled in the breathtaking Olympic Peninsula, all summer long!

Along our one-of-a-kind trail, discover family-owned lavender farms tucked close together, perfect for drivers and cyclists to enjoy hands-on experiences unique to each destination without traveling far.

As stewards of land and community, we cultivate unforgettable memories where every moment becomes a cherished story. We can't wait to be part of yours.

YOUR STORY BLOOMS HERE



Scan to learn more on our website

Guide brought to you by

SEQUIM LAVENDER TRAIL

DRIVING & CYCLING GUIDE



SEQUIM LAVENDER TRAIL
www.sequimlavender.org

SEQUIM LAVENDER TRAIL

Sequim, Washington

ATTRACTIONS

- 1 Dungeness Spit and National Wildlife Refuge
- 2 Dungeness River Nature Center
- 3 Sequim Museum & Arts
- 4 Olympic Theater Arts
- 5 Carrie Blake Park

FARM STANDS

- 1 Agnew Grocery
- 2 River Run Farm
- 3 Dungeness Valley Creamery
- 4 Chi's Farm
- 5 The Farm
- 6 River Road Flower Farm

RESTAURANTS

- 1 Cedars at Dungeness / Stymies
- 2 Sawadee Thai
- 3 Sergio's
- 4 Hi-Way 101 Diner
- 5 Salty Girls Seafood
Tedescos
- 6 Rainshadow Cafe
- 7 Alder Wood Bistro
- 8 Sunshine Cafe
- 9 Oak Table
- 10 Pacific Pantry
- 11 Nourish
- 12 Dockside Grill



There's no place in the world like the Sequim Lavender Trail – home to so many lavender farms – all close by!



www.sequimlavender.org